



CRUSH HOUSE PRIVATE DINING



Private Dining

UPDATED: 1.14.2025



CATERING PACKAGE OVERVIEW

Group & private dining guests have a variety of unique, beautiful room selections to choose from depending on the group size & style of the event. The Crush House is a modern industrial building that houses our state-of-the-art winery facility as well as a wine bar and eatery open to the public. The Crush House features casual Venetian-style lunches and dinners in a lively atmosphere.

At Gervasi, you will experience a stylish and elegant event in a beautiful and unique environment.



PRIVATE DINING OPTIONS & DETAILS

BELLINA ROOM (*Private*) - located inside the winery, on the ground level

- Dining packages are preplanned
- For parties with 12 guests or less, food can be ordered from standard dining menu.
- For available times and rates to reserve this space, please see [*The Crush House Group & Private Dining Fee Schedule*](#) on [page 8](#).

VINEYARD ROOM (*Private*) - located on the upper level

- Dining packages are preplanned
- For parties with 12 guests or less, food can be ordered from standard dining menu.
- For available times and rates to reserve this space, please see [*The Crush House Group & Private Dining Fee Schedule*](#) on [page 8](#).



INDOOR TOWER ROOM (*Semi-Private*) - located on the upper level

- In the Tower Room, guests are given the standard Crush House menu to order à la carte. Stop in for lunch or dinner and enjoy a variety of appetizers, soups, salads, sandwiches, pastas, and select entrées.
- **This room is exclusively booked online!** For available times and rates to reserve this space, please scan the QR Code.



BOOK HERE



PRIVATE DINING ROOMS

Enjoy cafe-style lunches or casual Venetian-style dinners with indoor dining available.

All rooms are located in a lively venue.



BELLINA ROOM

- 450 Sq. Ft. Private Room
- Located on first-story, inside the winery doors, wheelchair accessible
- No AV available
- Shared restrooms
- Ideal for groups 20-24 people



VINEYARD ROOM

- 319 Sq. Ft. Private Room
- Located on second-story, accessible by stairs, no elevator
- Ideal for groups 16-24 people
- Limited A/V available: High-definition TV for presentations
- Ideal for small showers and celebrations



TOWER ROOM *(exclusively booked online)*

- 244 Sq. Ft. Semi-Private Room
- Located on second-story, accessible by stairs, no elevator
- Comfortable Round table with peek-a-boo windows into winery fermentation room
- Curtain to define space
- Shared Restrooms
- Ideal for intimate dining and social gatherings
- Ideal for groups 8-12 people



CRUSH HOUSE FLOORPLAN

MAIN LEVEL

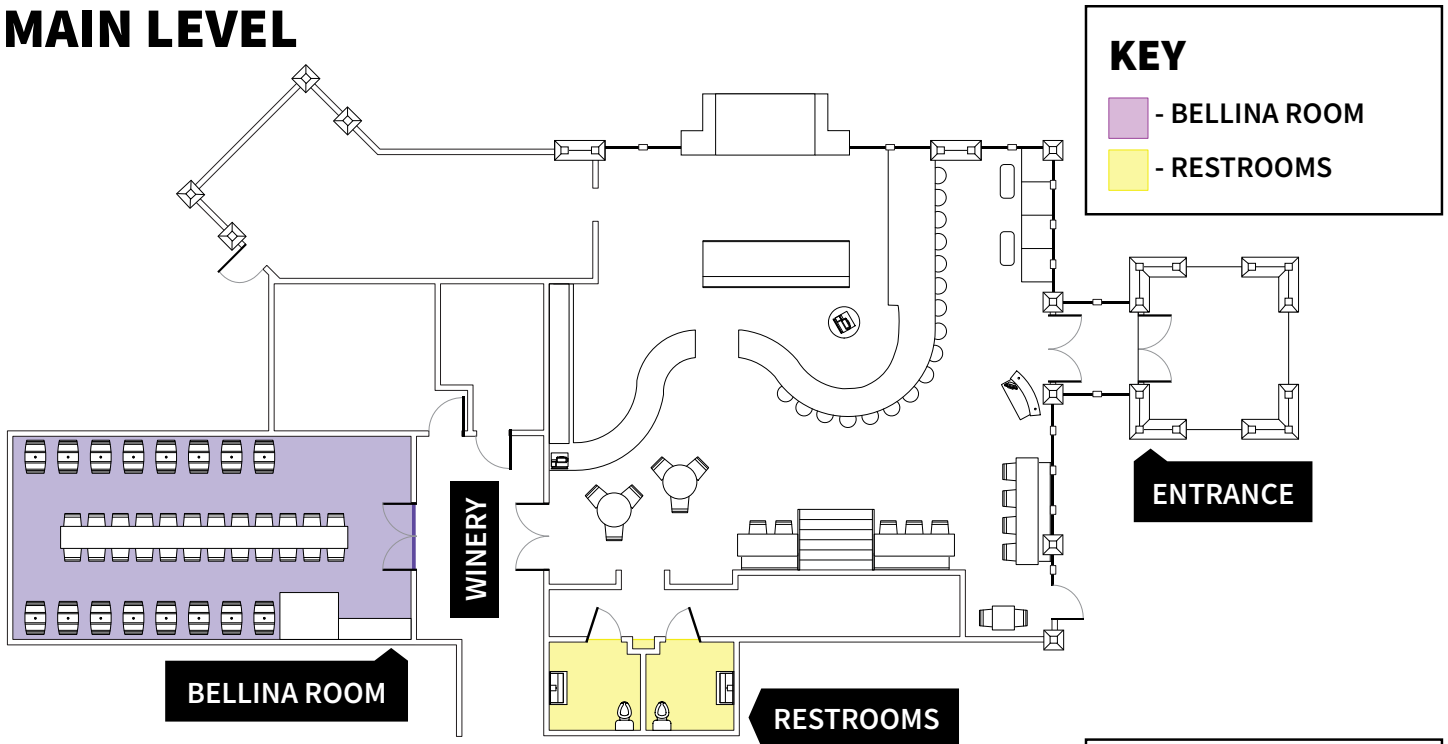

UPPER LEVEL*

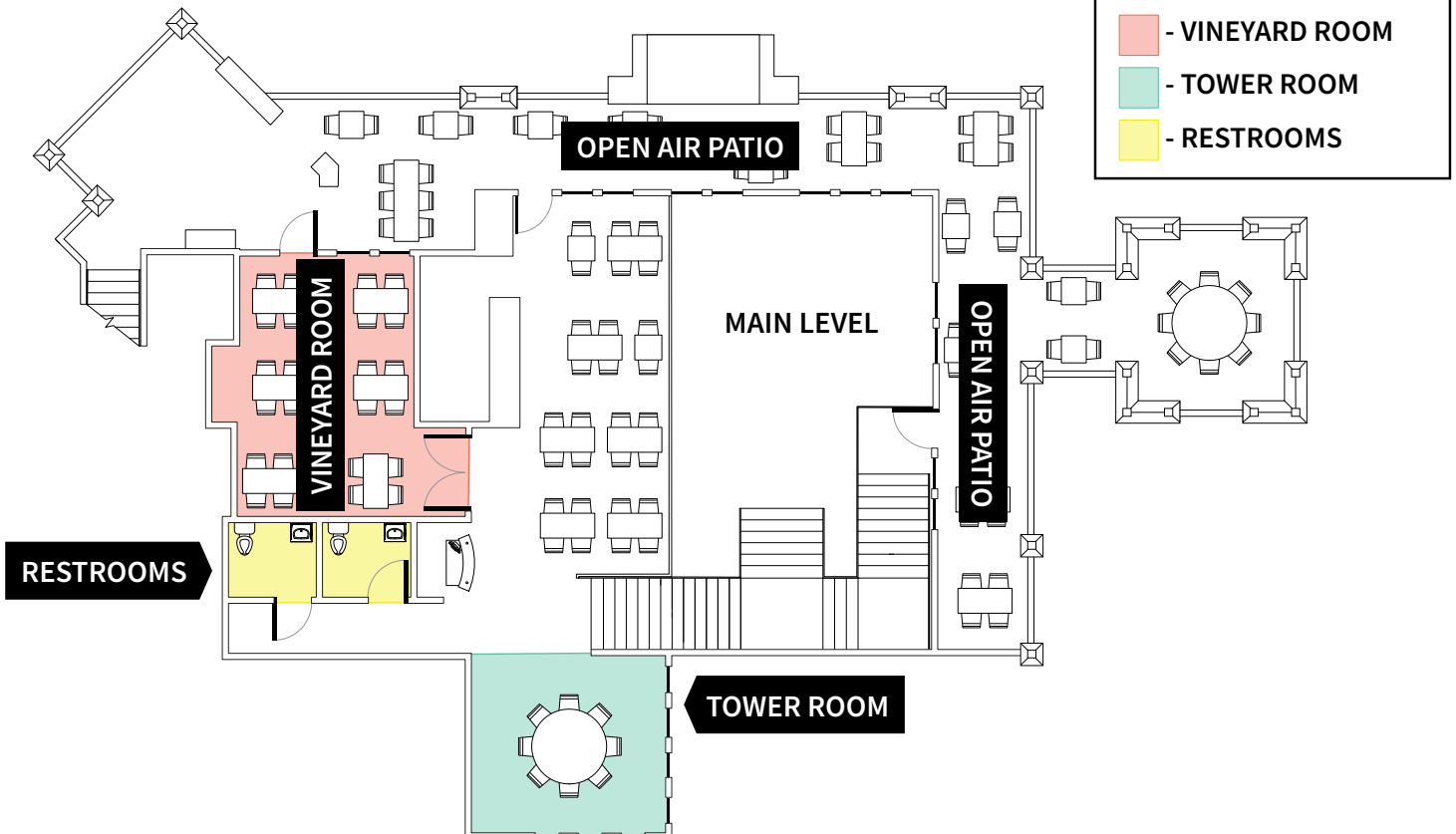



DINING OPTIONS

OPTION 1



Meatball Piada

OPTION 1

APPETIZERS *(Choose one - preselected)*

Served Family-Style; Additional Appetizers for \$6 per Person)

CALAMARI

bell peppers, marinara, cilantro aioli

ITALIAN LOADED POTATO CHIPS

crumbled pancetta, gorgonzola, scallions, tomatoes, blue cheese sauce, balsamic reduction

LOADED PITA CHIPS

short rib, black bean corn salsa, white cheddar, sliced jalapeños, jalapeño cream, lime crema

WHIPPED LEMON FETA SPREAD

tomatoes, cucumbers, pita chips, basil pesto

SALAD

SIMPLE SALAD

mixed greens, cucumbers, tomatoes, italian dressing

ENTRÉE *(Each Guest Selects One at the Event)*

CRUSH HOUSE BURGER

8 oz burger, egg bun, lettuce, tomato, onion, cheese

SHORT RIB SLIDERS

barbecue, creamy gorgonzola, caramelized onions

GRILLED CHICKEN PIADA

barbecue sauce, white cheddar, bacon, red onion

TOASTED SMOKED TURKEY WRAP

garlic herb wrap, bacon, provolone cheese, spinach, tomatoes, sweet mustard dipping sauce

MEATBALL PIADA

veal and beef*, arugula, provolone, spicy marinara, balsamic reduction
*can substitute with eggplant "meatballs"

\$26 PER PERSON

*(Does not include sales tax or gratuity)
All beverages charged per consumption.*

DESSERT *(Choose one - preselected | Additional cost of \$8 per person)*

FLOURLESS CHOCOLATE

TRUFFLE TORTE

crème anglaise, berry coulis, caramel, whipped cream, fresh berries

TIRAMISU

espresso reduction, whipped cream, fresh berries



DINING OPTIONS

OPTION 2



Crush House Burger

OPTION 2

APPETIZERS *(Choose one - preselected)*

Served Family-Style; Additional Appetizers for \$6 per Person)

CALAMARI

bell peppers, marinara, cilantro aioli

ITALIAN LOADED POTATO CHIPS

crumbled pancetta, gorgonzola, scallions, tomatoes, blue cheese sauce, balsamic reduction

LOADED PITA CHIPS

short rib, black bean corn salsa, white cheddar, sliced jalapeños, jalapeño cream, lime crema

WHIPPED LEMON FETA SPREAD

tomatoes, cucumbers, pita chips, basil pesto

SALAD

SIMPLE SALAD

mixed greens, cucumbers, tomatoes, italian dressing

ENTRÉE *(Each Guest Selects One at the Event)*

CRISPY CHICKEN LINGUINE

formaggio cheese sauce, broccoli, tomatoes, spinach, parmesan cheese

CRUSH HOUSE BURGER

8 oz burger, egg bun, lettuce, tomato, onion, cheese

GRILLED CHICKEN MARGHERITA

basil pesto, balsamic reduction, redskin mashed potatoes, seasonal vegetable

GRILLED CHICKEN PIADA

barbecue sauce, white cheddar, bacon, red onion

SEARED SALMON

cashews, mango plum glaze, mediterranean orzo, seasonal vegetable

SHRIMP LINGUINE

mushrooms, onions, tomatoes, spinach, olive oil, garlic, crushed red pepper

SHORT RIB GNOCCHI

mushrooms, spinach, caramelized onions, red wine demi glaze, parmesan cheese

\$34 PER PERSON

*(Does not include sales tax or gratuity)
All beverages charged per consumption.*

DESSERT *(Choose one - preselected | Additional cost of \$8 per person)*

FLOURLESS CHOCOLATE

TRUFFLE TORTE

crème anglaise, berry coulis, caramel, whipped cream, fresh berries

TIRAMISU

espresso reduction, whipped cream, fresh berries



DINING OPTIONS

OPTION 3



Grilled Pork Chop

OPTION 3

APPETIZERS *(Choose one - preselected)*

Served Family-Style; Additional Appetizers for \$6 per Person

CALAMARI

bell peppers, marinara, cilantro aioli

ITALIAN LOADED POTATO CHIPS

crumbled pancetta, gorgonzola, scallions, tomatoes, blue cheese sauce, balsamic reduction

LOADED PITA CHIPS

short rib, black bean corn salsa, white cheddar, sliced jalapeños, jalapeño cream, lime crema

WHIPPED LEMON FETA SPREAD

tomatoes, cucumbers, pita chips, basil pesto

SALAD

SIMPLE SALAD

mixed greens, cucumbers, tomatoes, italian dressing

ENTRÉE *(Each Guest Selects One at the Event)*

CRISPY CHICKEN LINGUINE

formaggio cheese sauce, broccoli, tomatoes, spinach, parmesan cheese

GRILLED CHICKEN MARGHERITA

basil pesto, balsamic reduction, redskin mashed potatoes, seasonal vegetable

GRILLED PORK CHOP

maple demi glaze, bacon onion jam, redskin mashed potatoes, seasonal vegetable

GRILLED NEW YORK STRIP STEAK

abbraccio sauce, redskin mashed potatoes, seasonal vegetable

SEARED SALMON

cashews, mango plum glaze, mediterranean orzo, seasonal vegetable

SHRIMP LINGUINE

mushrooms, onions, tomatoes, spinach, olive oil, garlic, crushed red pepper

\$59 PER PERSON

*(Does not include sales tax or gratuity)
All beverages charged per consumption.*

DESSERT *(Choose one - preselected | Additional cost of \$8 per person)*

FLOURLESS CHOCOLATE

TRUFFLE TORTE

crème anglaise, berry coulis, caramel, whipped cream, fresh berries

TIRAMISU

espresso reduction, whipped cream, fresh berries



PRIVATE DINING FEE SCHEDULE

PRIVATE DINING FEE AND FOOD/BEVERAGE MINIMUMS

GUIDELINES:

- Dining packages are preplanned for all event spaces in the Crush House, except the Tower Room. If there are 12 guests or less, you can order from the regular menu. In the Tower Room, guests are given the standard Crush House menu to order à la carte. Stop in for lunch or dinner and enjoy a variety of appetizers, soups, salads, sandwiches, pastas and select entrées.
- Beverages are ordered off The Crush House cocktail menu and are charged per consumption.
- All food & beverages are subject to 20% gratuity and applicable sales taxes.
- Gervasi Vineyard is closed for select holidays or may require custom quoting

FACILITY NAME & LOCATION	TYPE & DESCRIPTION	CAPACITY MAXIMUMS	WHEN	FOOD & BEV. MIN.	F & B EXTRA HOUR
ONLINE TOWER ROOM 244 Sq. Ft. Crush House	SEMI-PRIVATE Area in upper level with curtain to define space. Not Accessible. Shared restrooms on second level.	Single Table = 8-12	Mon. – Sat. Lunch & Dinner	\$35 per person per 2 hours  BOOK HERE	N/A
BELLINA ROOM 450 Sq. Ft. Crush House	PRIVATE Room in first level. Accessible. Shared restrooms on first level.	Single Table = 8-24	Mon. – Fri. Lunch Mon. – Sat. Dinner <u>No</u> Saturday Lunch	\$500 per 2.5 hrs \$800 per 2.5 hrs N/A	\$150 per hr \$250 per hr N/A
VINEYARD ROOM 319 Sq. Ft. Crush House	PRIVATE Room in upper level with limited A/V available. Not Accessible. Shared restrooms on second level.	Single Table = 16 Multiple Tables = 24	Mon. – Fri. Lunch Mon. – Thurs. Dinner Saturday Lunch (11:30 am-2 pm) <u>No</u> Fri. – Sat. Dinner	\$500 per 2.5 hrs \$800 per 2.5 hrs \$800 per 2.5 hrs N/A	\$150 per hr \$250 per hr \$250 per hr N/A

The Crush House Facility Rental Fees and Food & Beverage Minimums are subject to change without notice.

Please see the Crush House Event Agreement for all policies, procedures, and disclaimers.



SAMPLE CONTRACT - CRUSH HOUSE



RESTAURANT EVENT AGREEMENT

Client Contact:
SE GV Produced
(FIRST NAME, LAST NAME)
(ADDRESS)
(CITY, STATE, ZIP)
(PHONE)
(EMAIL)

Event Name : SE GV Produced Block ID #: 221351
Event Dates : **2023-01-01 to 2023-01-01**

PRIVATE EVENT ACCESS: Exclusive private interior and exterior access.

- Setup: Client will have access half an hour prior to start of event.
- Actual Event: See detail below.

FOOD & BEVERAGE MINIMUM: All Food & Beverage must be supplied by Gervasi.

- Food & Beverage Minimum (including unmet minimum) will incur a 20% service charge plus applicable taxes.
- Food & Beverage Minimums are based on the facility/room selected and the date of the event.
- Neither guest nor attendee will be permitted to remove any alcohol or alcoholic beverage from Gervasi. Any open bottles or partially empty alcoholic beverages will be retained by Gervasi, with the exception of Gervasi Wine. In accordance with prevailing laws, Gervasi will refuse to serve anyone under the legal drinking age of 21, Guests required to show a photo ID for proof of age.
- Gervasi reserves the right to refuse to serve alcohol to any guest(s) our staff deems appropriate, including inability to produce an official government issued I.D.
- Guests may enjoy Gervasi buffet and family style food (period up to 75 minutes) options for on-site consumption for a limited time, carry-outs not permitted on buffets.
- Gervasi reserves the right to increase menu pricing due to market price fluctuations at any time.
- All Food and Beverage must be supplied by Gervasi Vineyard. Outside desserts not provided by Gervasi will incur a \$1.50 per person charge, added to menu cost.

FEES & PAYMENT SCHEDULE:

Gervasi 1700, LLC does not accept cash, pre-paid credit or debit cards, Gervasi Gift & Loyalty Cards or checks for Event payments. Payments made by credit card will be subject to a 2.5% processing fee.

Payment to Secure Event Space: Deposit

- Deposit of 25% of the Food and Beverage Minimum is required to secure event date and time.
- Final guest count is required 7 days prior to the event, or original count will be considered a guaranteed count for final payment. No refund will be given after final payment is made,



SAMPLE CONTRACT - CRUSH HOUSE



GERVASI VINEYARD

THE BISTRO • THE CRUSH HOUSE • THE STILL HOUSE • THE CAVE

1700 55TH STREET NE CANTON, OH 44721 • PHONE | 330.497.1000 • FAX | 330.497.1008 • WWW.GERVASIVINEYARD.COM

RESTAURANT EVENT AGREEMENT

regardless of guest count. For additional guests after the final count is received, every effort will be made to accommodate additional guests. If more than 16 guests arrive day of the event, the only option is a buffet. Additional time is required to prepare and execute. Accurate counts prior to the event are needed to avoid a delay in preparation.

Final Payment: Due at Conclusion of Event:

- Any unmet food and beverage minimum will be charged as a facility rental fee at the conclusion of the event. This facility rental fee is subject to 20% gratuity.
- Happy Hour pricing is not valid on private events.
- Balance of all charges are due at the conclusion of the event.
- Refunds - In the event Event charges are LESS THAN monies previously paid, then Gervasi will issue an appropriate refund within 5 business days.

Note: Any amounts not paid to Gervasi will accrue interest after the date such payment was due at the rate of 18% per annum. Guest shall be responsible and shall reimburse Gervasi by scheduled date for all costs and expenses incurred by Gervasi in the collection of any amounts due from Guest; including, but not limited to attorney fees, court costs and other related expenses.

CANCELLATION POLICY: Gervasi Must Receive Notice of Cancellation in Writing

- Cancellation more than 20 days prior to event results in a full refund of deposit.
- Cancellation from 20-10 days prior to the event, forfeiture of 50% of the deposit.
- Cancellation from 9-0 days prior to the event, 100% forfeiture of deposit plus 50% of Food and Beverage Minimum
- Customer agrees that cancellation during the time periods set forth above will cause Gervasi to incur losses of types and in amounts which are impossible to compute and ascertain with certainty, and that the cancellation payment required by the cancellation policy above is liquidated damages that represent a fair, reasonable and appropriate estimate thereof.
- Accordingly, in the event of a cancellation, Customer agrees to pay the amounts set forth in the Cancellation Policy hereinabove as liquidated damages (the "Cancellation Payment"), upon payment of which Customer shall have no further obligation to Gervasi. Such Cancellation Payment is intended to represent estimated actual damages and are not intended as a penalty. Further, Customer agrees and acknowledges that it shall not be entitled to any services, food or beverages from Gervasi in exchange for the required Cancellation Payment.
- A one-time date change, if available, may be accommodated in accordance with the cancellation policy stated above. Any additional date changes may incur a date change fee.

DISCLAIMER:

- Gervasi reserves the right to monitor all events. In order to prevent damage to the fixtures and furnishings; banners or display items may not be affixed to any wall, floor, window or ceiling with nails, staples, tape or



SAMPLE CONTRACT - CRUSH HOUSE



GERVASI VINEYARD

THE BISTRO • THE CRUSH HOUSE • THE STILL HOUSE • THE CAVE

1700 55TH STREET NE CANTON, OH 44721 • PHONE | 330.497.1000 • FAX | 330.497.1008 • WWW.GERVASIVINEYARD.COM

RESTAURANT EVENT AGREEMENT

any other substance. Guest agrees to be responsible for any damage done to the facility or any other part of the property by the Guest and/or its invitee's, employees, independent contractors, or others under Guest's control. Liability for damages to the facility or any other part of the property will be charged to the Guest accordingly, minimum fee \$250

- The use of fireworks, sparklers, cigar/cigarettes (including favors) or any other type of flammable items is strictly prohibited inside the buildings on property.
- Gervasi is not liable for damage to or loss of items, equipment or personal property belonging to the Guest and/or its invitees, employees or independent contractors.
- Gervasi shall not be liable for the non-performance of this Agreement when said non-performance is attributable to labor disputes; strike; accident; government regulation; unavailability of food or beverage; riot; national emergency; act of God and/or other causes whether listed herein or not, which are beyond the reasonable control of Gervasi. In the event of the non-performance of this Agreement for any of the above-referenced reasons contained in this paragraph, Guest shall be entitled to a complete refund of their deposit and all other payments made, and there shall be no further liability by and between the parties.
- A guest may not assign his/her/its interests under this Agreement without the written approval of Gervasi.
- This Agreement represents the entire agreement of the parties and supersedes any other agreements or understandings, written or oral, between the parties with respect to the event.
- This Agreement shall be construed under and interpreted in accordance with the laws of the State of Ohio.
- The parties agree that any claim arising out of or in any way related to this Agreement shall be brought in the Common Pleas Court of Stark County, Ohio and the parties expressly consent to personal jurisdiction and venue in said Court.

I HAVE COMPLETELY READ AND AGREE TO BE BOUND BY THE TERMS AND CONDITIONS CONTAINED IN THIS AGREEMENT.

COMPANY/ORGANIZATION: SE GV Produced

EVENT DATE: **2023-01-01 - 2023-01-01**

Signature:

(Print Name): (FIRST NAME, LAST NAME)

If Corporate Group, Title:

Signed Agreement must be returned no later than: (DATE)

Gervasi Representative: **GV Event Sales**

GERVASI 1700, LLC, dba GERVASI VINEYARD RESORT AND SPA ("Gervasi")



GERVASI WALKING PATHS